

PLINTH BEAM	BEAM SIZE (bxd)	BOTTOM STEEL		TOP STEEL		8 TOR RINGS
		THROUGH TB	EXTRA TB	THROUGH TT	EXTRA TT	
PB1,PB2,PB3, PB4,PB5,PB6	230X300	2-16 TOR	2-16 TOR	2-16 TOR	2-16 TOR	150 C/C
PB7,PB8	230X450	3-16 TOR	2-16 TOR	2-16 TOR	3-16 TOR	150 C/C
PB9	230X300	2-16 TOR	2-16 TOR	2-16 TOR	2-16 TOR	150 C/C
PB10,PB11	230X300	2-16 TOR	2-16 TOR	2-16 TOR	2-16 TOR	150 C/C
PB12	230X450	3-16 TOR	2-16 TOR	2-16 TOR	3-16 TOR	150 C/C
PB13,PB14, PB15,PB16	230X300	2-16 TOR	2-16 TOR	2-16 TOR	2-16 TOR	150 C/C
PB17,PB18,PB19, PB20,PB21,PB22	230X300	2-16 TOR	2-16 TOR	2-16 TOR	2-16 TOR	150 C/C
PB23,PB24,PB25, PB26,PB27,PB28	230X300	2-16 TOR	2-16 TOR	2-16 TOR	2-16 TOR	150 C/C
PB29,PB30,PB31	230X450	3-16 TOR	2-16 TOR	2-16 TOR	3-16 TOR	150 C/C
PB32,PB33	230X300	2-16 TOR	2-16 TOR	2-16 TOR	2-16 TOR	150 C/C
PB34,PB34A	230X300	2-16 TOR	2-16 TOR	2-16 TOR	2-16 TOR	150 C/C
PB35,PB37	230X300	2-16 TOR	2-16 TOR	2-16 TOR	2-16 TOR	150 C/C
PB36	230X450	3-16 TOR	2-16 TOR	2-16 TOR	3-16 TOR	150 C/C
PB38,PB40	230X300	2-16 TOR	2-16 TOR	2-16 TOR	2-16 TOR	150 C/C
PB39	230X450	3-16 TOR	2-16 TOR	2-16 TOR	3-16 TOR	150 C/C
PB41,PB42,PB43, PB44	230X300	2-16 TOR	2-16 TOR	2-16 TOR	2-16 TOR	150 C/C
PB45,PB46,PB47, PB48,PB49	230X300	2-16 TOR	2-16 TOR	2-16 TOR	2-16 TOR	150 C/C
PB50,PB51,PB52, PB53,PB54	230X300	2-16 TOR	2-16 TOR	2-16 TOR	2-16 TOR	150 C/C
PB55,PB56,PB57, PB58,PB59	230X300	2-16 TOR	2-16 TOR	2-16 TOR	2-16 TOR	150 C/C
PB9A	400X400	2-16 TOR	2-16 TOR	2-16 TOR	2-16 TOR	150 C/C

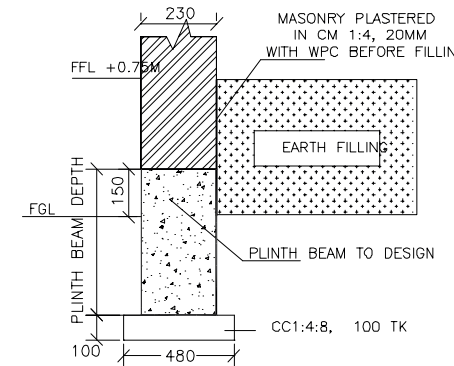

TYPICAL CROSS SECTION OF PLINTH BEAM

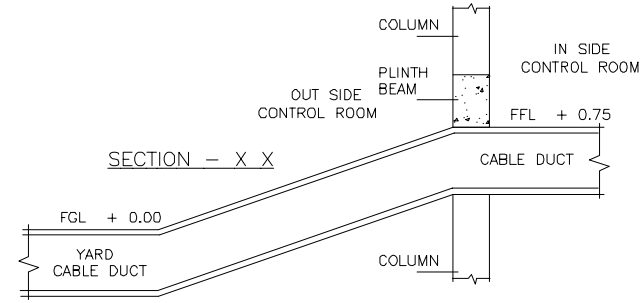

SECTION - X X

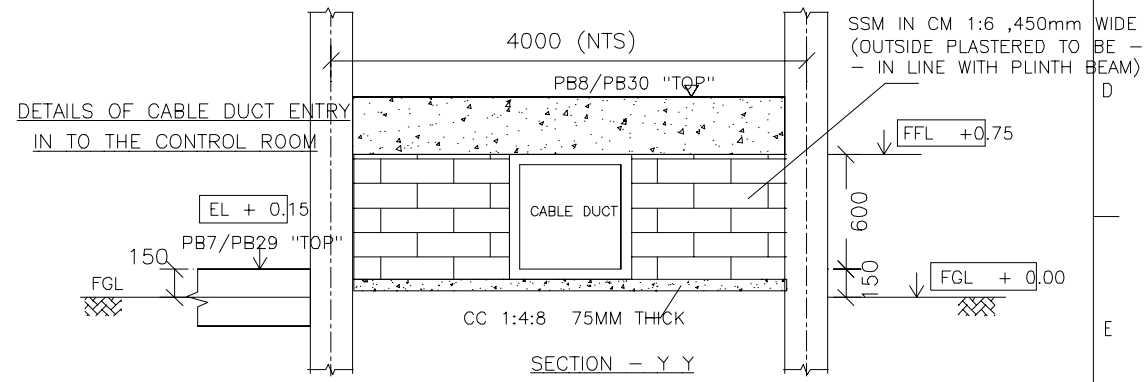

DETAILS OF CABLE DUCT ENTRY
IN TO THE CONTROL ROOM

SECTION - Y Y

- NOTES:
1. ALL DIMENSIONS ARE IN MMS, UNLESS OTHERWISE SPECIFIED.
 2. DO NOT SCALE OUT THIS DRG, FOLLOW ONLY THE WRITTEN DIMENSIONS.
 3. ANY DISCREPANCY FOUND MAY PLEASE BE BROUGHT TO THE NOTICE OF THIS OFFICE BEFORE EXECUTION.
 4. OTHER PORTIONS OF CONTROL ROOM BUILDING SHALL BE DESIGNED FOR FIRST FLOOR LOADS ALSO TO ACCOMMODATE OFFICES.
 5. ALL STRUCTURAL CONCRETE SHALL BE M20 GRADE.
 6. STEEL REINFORCEMENT SHALL CONFORM TO IS 1786/1979 OF GRADE Fe 415

KARNATAKA POWER TRANSMISSION CORPORATION LTD					
220KV SUB STATION		PLINTH BEAM DETAILS		SHEET 2 OF 2	
DRG NO: CEE(P & C)/SE(C)/06-07/220/004					
HDM	AEE(C)	SE(CIVIL)	CHIEF ENGINEER ELE		PLANNING AND CO ORDINATION
DRN	DGN	CHD	REC	APPROVED	